

EXAMPLE PLANS

The drawing shows the plans required for a typical two-storey rear extension. Note that the plan has been photographically reduced. The notes describe some of the important points.

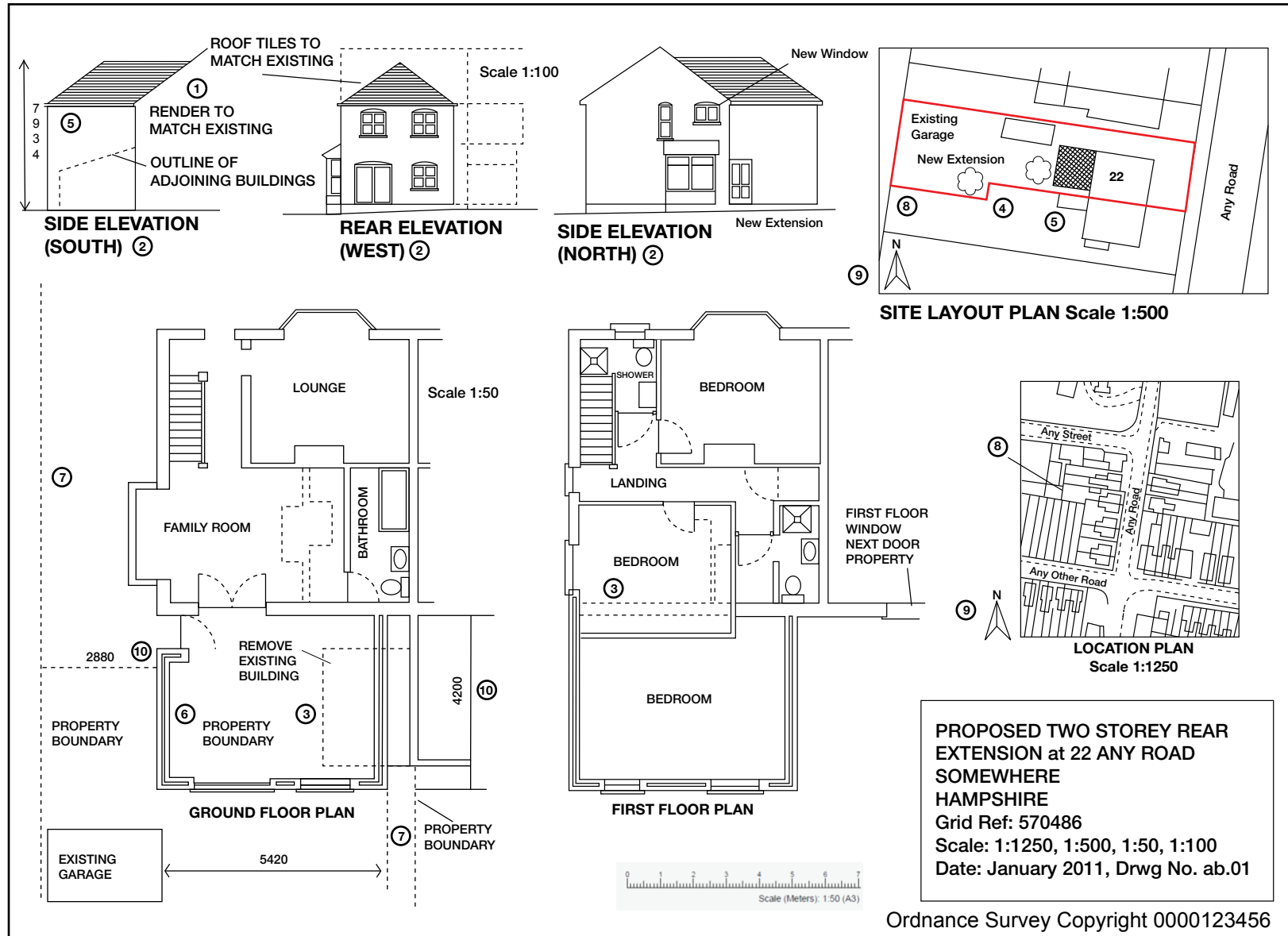

PROPOSED TWO STOREY REAR EXTENSION at 22 ANY ROAD SOMEWHERE HAMPSHIRE
 Grid Ref: 570486
 Scale: 1:1250, 1:500, 1:50, 1:100
 Date: January 2011, Drwg No. ab.01

Ordnance Survey Copyright 0000123456

1. Mark up the drawings to show what building materials are proposed.
2. Include all elevations of your extension.
3. Use dotted or broken lines to show the position of existing buildings to be demolished.
4. Trees to be retained or felled should be shown.
5. Make sure the position of adjacent properties is up to date and accurate.
6. Highlight new work, using colour or hatching.
7. Show property boundaries.
8. Outline your site in red.
9. Show the north point on the plan.
10. Each plan must be drawn to a metric scale which should be stated. Include scale bars/key dimensions. Any dimensions should be included on the plans in metres.
11. Show 2 named roads or a junction/house names or numbers.
12. Valid, up-to-date Ordnance Survey Copyright Licence number.
13. State the grid reference (rural areas only).